

OBSOLETE
PARTS MAY NOT BE AVAILABLE

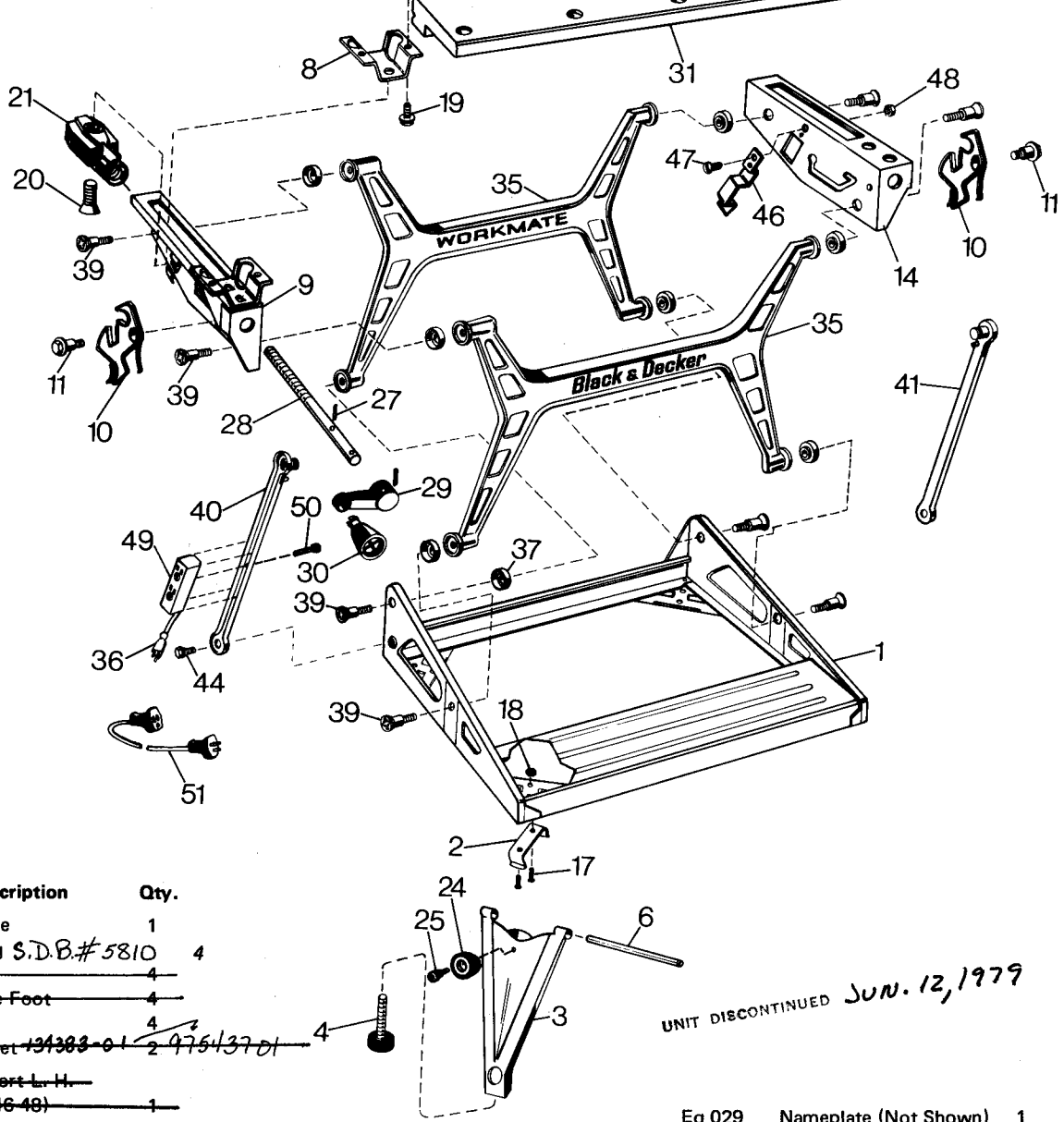

Item No.	Part No.	Description	Qty.
1	976697-01	Base Frame	1
2	976248	Leg Spring S.D.B.# 5810	4
3	976690-01	Leg (Adj.)	4
4	975408	Adjustable Foot	4
6	975188-01	Axle	4
8	975437-01	Top Bracket	2
9	976017	Vise Support L. H.	1
10	976417	Plastic Latch Lever	2
11	976419	10-32 Shoulder Screw	2
14	976018	Vise Support R. H.	1
16	976066	Caution Label	1
17	99460-10	10-32 x 5/8 Screw	8
18	406	10-32 Nut	8
19	976763	Screws	8
20	975389	5/16-18 x 3/4 F.H.M.	2
21	134384-04	Screw	2
24	975870	Pivot Nut	2
25	976694	Bumper	4
27	976029	Roll Pin	4
28	976247	Vise Screw 134385	2
29	975877	Handle Arm 134386	2
30	975870	Snap-in Handle 820728	2
31	135033	Vise Jaw & Nameplate	2

Item No.	Part No.	Description	Qty.
35	975149	H-Frame 976347	2
36	99586-01	Att. Plug 234900-01	1
37	975365	Cup Washer	8
39	975153	Shoulder Screw	8
40	975392-05	Side Stay L. H.	1
41	975393-05	Side Stay R. H.	1
44	975457	10-32 Self-Tap Shoulder Screw	2
45	975955	Swivel Grip 135693	4
46	976217-01	Latch	2
47	99248-06	8-32 x 3/8 Screw	2
48	407	8-32 Nut	2
49	976564	Elec. Outlet	1
50	99318-16	8-32 x 1" Pan Hd. Screw & Washer	1
51	976563-01	Extension Cord	1

UNIT DISCONTINUED JUN. 12, 1979

Eq 029 Nameplate (Not Shown) 1

IMPORTANT!—To assure product SAFETY and RELIABILITY, repairs, maintenance and adjustment should be performed by BLACK & DECKER Service Centers or other qualified service organizations, always using BLACK & DECKER replacement parts.

WHEN ORDERING REPLACEMENT PARTS YOU MUST GIVE UNIT, TYPE AND CATALOG NUMBER AS SHOWN ON NAMEPLATE, PLUS PART NUMBER AND NAME OF PART NEEDED.

DELUXE DUAL HEIGHT WORKMATE

Cat. No. 79-004 Type 1

Black & Decker (U.S.) Inc. Towson, Maryland 21204

Printed in U.S.A. Bulletin No. 9131

943147-00

COPYRIGHT© 2005. All Rights Reserved.

Parts list, pricing, and availability subject to change. Please visit www.dewaltservicenet.com for current parts information.