

OBSOLETE
PARTS MAY NOT BE AVAILABLE

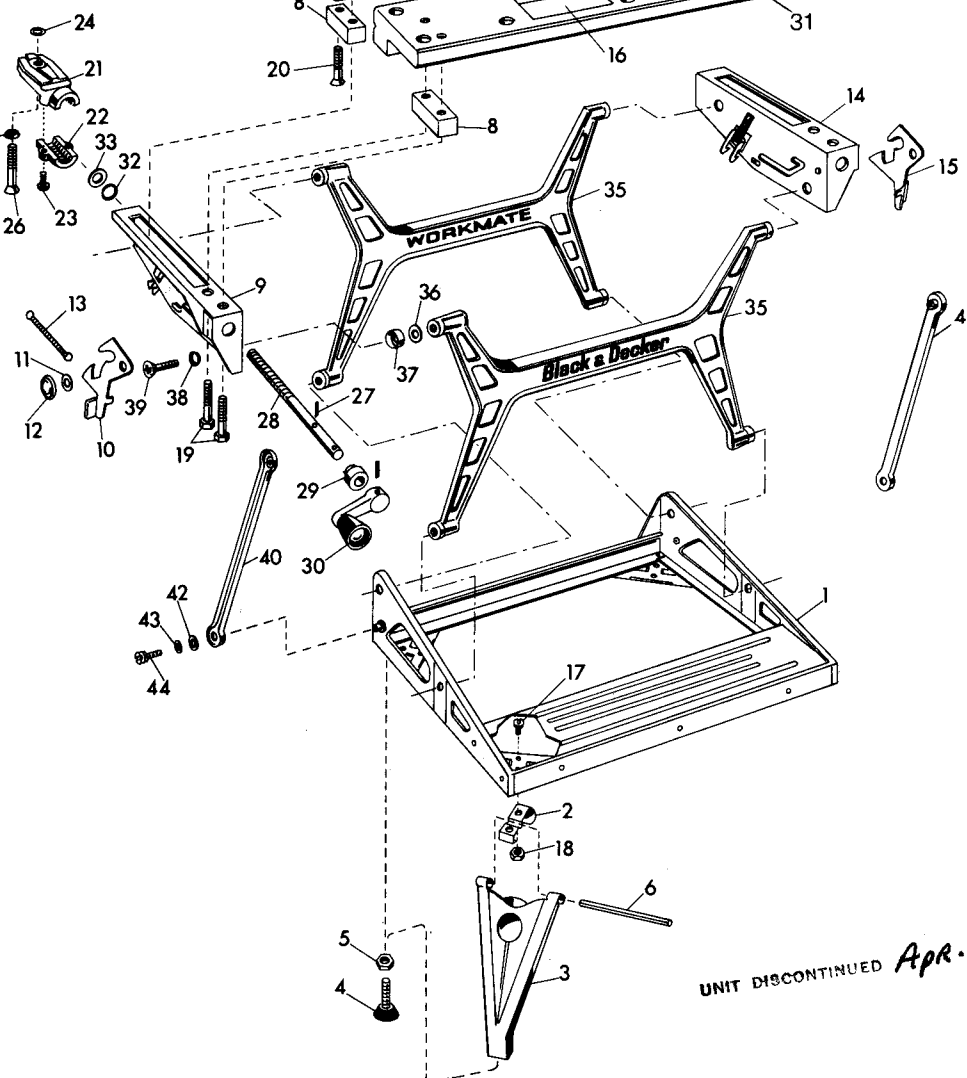

UNIT DISCONTINUED *Apr. 1, 1976*

Item No.	Part No.	Description	Qty.	Item No.	Part No.	Description	Qty.
1	975279	Base Frame <i>975451-01</i>	1	23	975236	8-32 x 9/16 P.H.M. Screw	4
2	975156	Leg Spring	4	24	975150	Nylatron Washer	2
3	975144-01	Leg Assembly <i>976690-01</i>	4	25	975158	Nylatron Washer <i>975154</i>	2
4	975166	Adjustable Foot <i>975408</i>	8	26	975152	5/16-18 x 2" F.H.M. Screw	2
5	99366-03	5/16-18 Hex Jam Nut	8	27	<i>976029</i>	Roll Pin <i>975347</i>	4
6	975188-01	Axle	4	28	894260	Vise Screw <i>976244</i>	2
7	975163	Vice Jaw	1	29	975197-01	Thrust Bushing	2
8	975139	Slide Bracket	4	30	432778	Handle Assembly <i>975896</i>	2
9	975147	L.H. Vice Bracket and Catch	1	31	975346	Vice Jaw & Nameplate (Inc. 16)	1
10	975190-01	L.H. Latch Lever	1	32	54831	Spring Washer	2
11	975140	Nylatron Washer <i>723105</i>	4	33	51332	Flat Washer	2
12	975207	Cap	2	35	975143	"H" Frame <i>976347</i>	2
13	975186	Spring	2	36	975154	Nylatron Washer	8
14	975148	R.H. Vice Bracket and Catch	1	37	975202	Cup Washer <i>975365</i>	8
15	975191-01	R.H. Latch Lever	1	38	975155	Nylatron Washer	8
16	975268	Caution Label	1	39	975153	Shoulder Screw	8
17	99460-10	10-32 x 3/8" Screw	8	40	975160	L.H. Side Stay	1
18	406	10-32 Nut	8	41	975161	R.H. Side Stay	1
19	99185-28	5/16-18 x 1 3/4" Hex Bolt	4	42	99360-06	Washer	2
20	975151	5/16-18 x 1 5/8" F.H.M. Screw	2	43	99360-04	Washer	4
21	975141	Half Nut (Top)	2	44	99354-08	10-32 x 1/2" P.H.M. Screw	4
22	975140	Half Nut (Bottom)	2	45	975165	Swivel Grip	4

NOTES
29,32 Not used with handles with plastic arms.
94386 → *943147-00*
820728

IMPORTANT!—To assure product SAFETY and RELIABILITY, repairs, maintenance and adjustment should be performed by BLACK & DECKER Service Centers or other qualified service organizations, always using BLACK & DECKER replacement parts.

WHEN ORDERING REPLACEMENT PARTS YOU MUST GIVE UNIT, TYPE AND CATALOG NUMBER AS SHOWN ON NAMEPLATE, PLUS PART NUMBER AND NAME OF PART NEEDED.

WORKMATE
Cat. No. 79-001 Type 1

The Black & Decker Mfg. Co.
Towson, Maryland 21204

Printed in U.S.A. Bulletin No. 8508-1

COPYRIGHT© 2005. All Rights Reserved.

Parts list, pricing, and availability subject to change. Please visit www.dewaltservicenet.com for current parts information.