

OBSOLETE
PARTS MAY NOT BE AVAILABLE

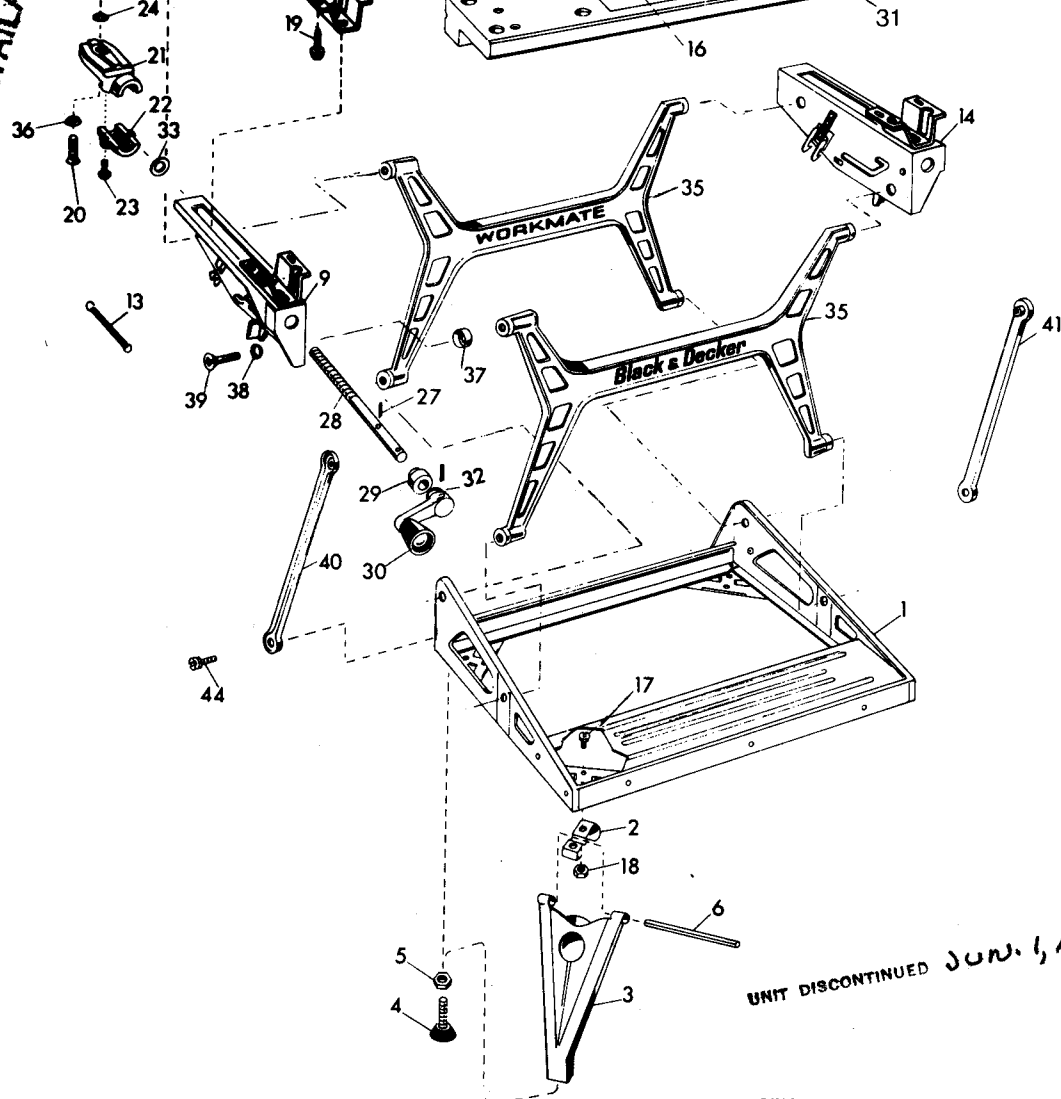

UNIT DISCONTINUED JUN. 1, 1976

| Item No. | Part No. | Description | Qty | Item No. | Part No. | Description | Qty |
|---------------|----------------------|---|--------------|---------------|----------------------|---|--------------|
| 1 | 975279 | Base Frame 975451-01 | 1 | 24 | 975150 | Nylatron Washer | 2 |
| 2 | 975156 | Leg Spring | 4 | 27 | 975347 | Roll Pin 976029 134385 | 4 |
| 3 | 975144-01 | Leg Assembly 976690-014 | 4 | 28 | 975187 | Vice Screw 976049 | 2 |
| 4 | 975408 | Adjustable Foot | 8 | 29 | 975197-01 | Thrust Bushing | 2 |
| 5 | 99366-03 | 5/16-18 Hex Jam Nut | 4 | 30 | 132778 | Handle Assembly 995076 975077 | 2 |
| 6 | 975188-01 | Axle 134383-01 | 4 | 31 | 975411 | Vice Jaw & Nameplate (inc. 16) | 2 |
| 8 | 975370-01 | Top Bracket 975439-012 | 2 | 32 | 54831 | Spring Washer | 2 |
| 9 | 975380 | L.H. Vice Support 976137-011 | 1 | 33 | 51332 | Flat Washer | 2 |
| 13 | 975186 | Spring | 2 | 35 | 975143 | "H" Frame 976347 | 2 |
| 14 | 975379 | R.H. Vice Support 976136-011 | 1 | 36 | 975154 | Nylatron Washer | 2 |
| 16 | 975387 | Caution Label Nameplate | 1 | 37 | 975365 | Cup Washer | 8 |
| 17 | 99460-10 | 10-32 x 5/8 Screw | 8 | 38 | 975155 | Nylatron Washer | 8 |
| 18 | 406 | 10-32 Nut | 8 | 39 | 975153 | Shoulder Screw | 8 |
| 19 | 975413 | 11 x 3/4 Hex Hd. Wood Screw | 8 | 40 | 975392-01 | L.H. Side Stay | 1 |
| 20 | 975389 | 5/16-18 x 3/4 F.H.M. Screw | 2 | 41 | 975393-01 | R.H. Side Stay | 1 |
| 21 | 975141 | Half Nut (Top) | 2 | 44 | 975457 | 10-32 Self Tap Shoulder Screw | 2 |
| 22 | 975140 | Half Nut (Bottom) | 2 | 45 | 975384 | Swivel Grip 135693 | 4 |
| 23 | 975236 | 8-32 x 9/16 P.H.M. Screw | 4 | | 525011-00 | 242441-00 | |

NOTES:

- 29, 32 Not used with handles with plastic arms.
- 44 Some units built with 99354-08 10-32 x 1/2" Machine Thread Screws using 99360-06 and 99360-04 Washers. 943147-00



IMPORTANT!—To assure product SAFETY and RELIABILITY, repairs, maintenance and adjustment should be performed by BLACK & DECKER Service Centers or other qualified service organizations, always using BLACK & DECKER replacement parts.

WHEN ORDERING REPLACEMENT PARTS YOU MUST GIVE UNIT, TYPE AND CATALOG NUMBER AS SHOWN ON NAMEPLATE, PLUS PART NUMBER AND NAME OF PART NEEDED.

WORKMATE

Cat No. 79-001 Type 2

The Black & Decker Mfg. Co.
Towson, Maryland 21204

Printed in U.S.A. Bulletin No. 8554-3

976763

COPYRIGHT© 2005. All Rights Reserved.

Parts list, pricing, and availability subject to change. Please visit www.dewaltservicenet.com for current parts information.