

CRAFTSMAN®

Sears

... WHERE AMERICA
SHOPS FOR VALUE

TOOLS

1981 Spring Catalog of Power and Hand Tools

INDEX ON PAGE 88

Last date to order from this catalog
is July 31, 1981

SEARS, ROEBUCK AND CO.

Satisfaction Guaranteed or Your Money Back

KT Please mention the key letter at left
when ordering by phone from this catalog



**IT'S SO EASY TO SHOP BY PHONE
FROM ANY SEARS CATALOG**

Just call Sears and say you want to place a catalog order

You can also apply by phone for a Sears Credit Card
to make Sears Catalog or Retail shopping easier yet

Need a sturdy work center that's lightweight and portable so you can take it right to the job?

CRAFTSMAN® Portable Workbench/Vise sets up anywhere to handle a variety of household jobs

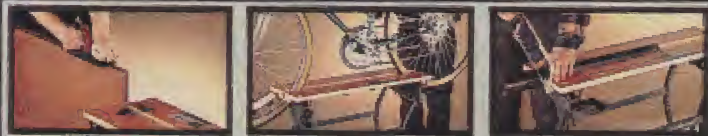

Plane doors vise grips stock up to 5 1/4 inches wide

Adjusts to 2 working heights holds awkward pieces like bikes

V-grooves in vise jaws let you work on tubular pieces

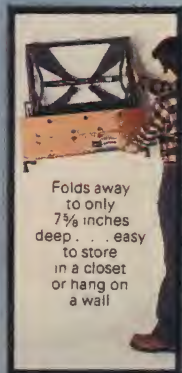

Folds away to only 7 3/8 inches deep... easy to store in a closet or hang on a wall



Fold legs under and workbench is at sawhorse height

PRICED \$15 LESS than our 1980 Fall Tool Book, page 84
\$74.99

TOP, FRAME: Pressed flakeboard top. Strong steel frame. Base step can be used as footrest for added stability. Legs adjust to 2 heights.

WISE: Jaws open to 5 1/4 in. wide. Double-adjustment levers permit gripping of wedge-shaped objects. 4 swivel pegs hold irregular-shaped or circular pieces. V-grooves in vise jaws hold tubular pieces like pipe.

DIMENSIONS, CAPACITY: Height of work surface is 31 3/8 in. with legs open, 23 1/8 in. with legs closed. Folds away to 29 1/2 x 29 x 7 3/8 inches. Work table is 15 1/4 in. wide with vise open, 9 3/8 in. wide with vise closed. Capacity using two swivel clamps is 12 in. when work is held parallel to clamps, 28 in. when held diagonally. Weighs only 32 pounds... lightweight and easy to carry. Supports 350 lbs. Imported.

ORD INFO: "N" note, p. 89. 1980 Fall Tool Book price \$89.99.
9 KT 28876N—Shipping weight 35 pounds \$74.99

CRAFTSMAN® Portable Workbench/Vise has single working height, tool box in frame. PRICED \$8 LESS than our 1980 Fall Tool Book, page 84.

TOP, FRAME: Pressed flakeboard top. Steel frame. Rest foot on rubber-padded crossbrace for added stability. Imported.

WISE: Jaws open to 5 1/4 in. wide. Swivel grips hold irregular-shaped, round objects. V-grooves in vise jaws hold tubular pieces as pipe in horiz., vert. positions.

DIMEN, CAPACITY: Overall size: open, 32 x 23 1/2 x 31 1/4 in. high; folded, 32 x 5 1/2 x 36 1/4 in. high. Swivel grips hold objects up to 12 in. wide held parallel to clamps, 21 in. held diag. 350-lb. cap.

ORDERING INFO: Incl. tool box that fits in frame to hold swivel grips, tools, small parts. See "N" suffix, p. 89. 1980 Fall Tool Book price \$47.99.
9 KT 5172N—Wt. 24 lbs. \$39.99



\$39.99

New at Sears . . . Accessories for Workbenches

For added versatility and precision when using your workbench

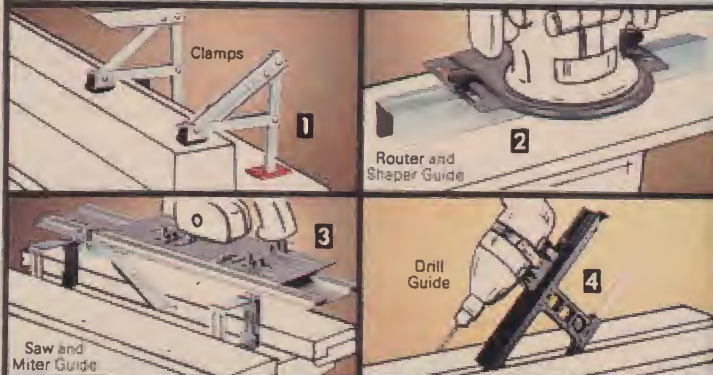

(1) Clamps

USES: Secure workpiece to workbench for gluing, sanding, drilling, sawing or routing. Fit into holes on jaws of workbench/vises sold on this page or any surface with 3/4-in. holes. Hold items up to 3 3/4 in. thick with up to 150 lbs. of clamping force.

CONSTRUCTION: Steel.

ORDER INFORMATION: Fits all workbenches shown on this page. Set of 2.

Shipping wt. 1 lb. 2 oz.
9 KT 51723 Set \$12.99

(2) Router and Shaper Guide

USES: Use with router with up to 6-inch diameter base plate to help make your molding of other designs on workpieces secured on the workbench. Works on wood up to 1 1/2 inch thick. Maximum diameter of cutter is 1 inch.

CONSTRUCTION: Steel.

ORDERING INFO: Fits all workbenches on this page.

Shipping wt. 3 lbs. 9 oz.
9 KT 51725 \$16.99

(3) Saw and Miter Guide

USES: Makes intricate precision cutting easier and more accurate. Accepts circular saws of 7 1/4 inches or smaller, with maximum shoe length of 15 inches. Works on materials up to 2 1/4 inches thick, with accurate 30° sawing of material up to 7 3/4 in. wide and 90° sawing of material up to 17 in. wide.

CONSTRUCTION: Steel.

ORDERING INFO: Fits all workbenches on this page.

9 KT 51724C—Wt. 6 lbs. 9 oz. \$25.99

(4) Drill Guide

USES: For use with 1/4-in. and 3/8-in. drill and any workbench unit. Holes can be drilled at 5° increments between 0° and 90°. Adjustable depth stop prevents drilling beyond desired depth. Incl. level with horizontal and vertical bubble indicator. Adjustable for free-hand use.

CONSTRUCTION: Plastic.

ORDER INFO: Fits all workbenches on this page. Wt. 1 lb. 8 oz.

9 KT 51726 \$12.99



CRAFTSMAN® Solid-maple Woodworker's Bench with end and side vises

CONSTRUCTION: Solid, kiln-dried maple table, legs, crossbraces, tool tray and vise jaws. Steel vise handles, screws, guide rods. 37x75x33 inches high overall.

WORK SURFACE: 15 3/8 x 70 in. long. Four dogs hold two 1 1/2-in. long maple clamping bars in place. Dogs fit into 14 pairs of holes 4 1/2 in. apart on table top, vise. 78 1/2-in. clamping cap.

END VISE: 3x5 1/2 inch face. Two guide rods. 10 1/2-inch capacity.

SIDE VISE: Maple shoulder design secures workpieces for chiseling, carving, planing and sanding. 5 3/4-inch capacity.

TOOL TRAY: 34x8 1/4 x 2 inches deep. Mounts on side or end of table.

DRAWERS: Two maple drawers with press-board bottoms. Each 14x3 1/2 x 9 1/2 in. wide.

LEGS: Trestle style with crossbraces. Table end with side vise has leg with four supports for lateral stability.

ORDERING INFO: Partially assembled. See "T" shipping note on page 89.

T 9 KT 10231N—Wt. 175 lbs. \$349.99

Tabletop Workbench/Vise

Can tilt and be locked at any angle from 0° to 90°



\$29.99

PRICED \$10 LESS than our 1980 Fall Tool Book, page 84. Holds pieces for sawing, carving, sanding, planing, etc. Tilts to any position from 0° to 90° for use as a drafting table, easel or drawing board. Holes in base for mounting to bench.

TOP, FRAME: Pressed flakeboard top with rugged steel frame. Imported.

WISE: Jaws open 5 inches wide. V-grooves in vise face permit rigid vertical grasping. Double-adjustment levers permit gripping of wedge-shaped objects. Four swivel pegs.

DIMENSIONS: Work table 15 inches wide with vise open, 10 inches closed. Includes all necessary hardware and instructions.

ORDERING INFO: Unassembled. 1980 Fall Tool Book price \$39.99.

9 KT 28893—Wt. 12 lbs. 8 oz. \$29.99